

Pinnacle Peak Park Trail

Park hours vary through the year and are on the park website. Entering or remaining in the park during closed hours is strictly prohibited.

Trail Notes:

- Distance: 2 miles one way
- No restroom or water available on the trail
- The brown (PK) markers 6-8 inches tall along the trail represent 100-foot distances for guiding emergency services.



Revised September 2022

Notice: This document is provided for general information purposes only.

The City of Scottsdale does not warrant its accuracy, completeness, or suitability for any particular purpose. It should not be relied upon without field verification.



Legend

- Main Trail
- Park Boundary
- Viewpoints
- Emergency Markers

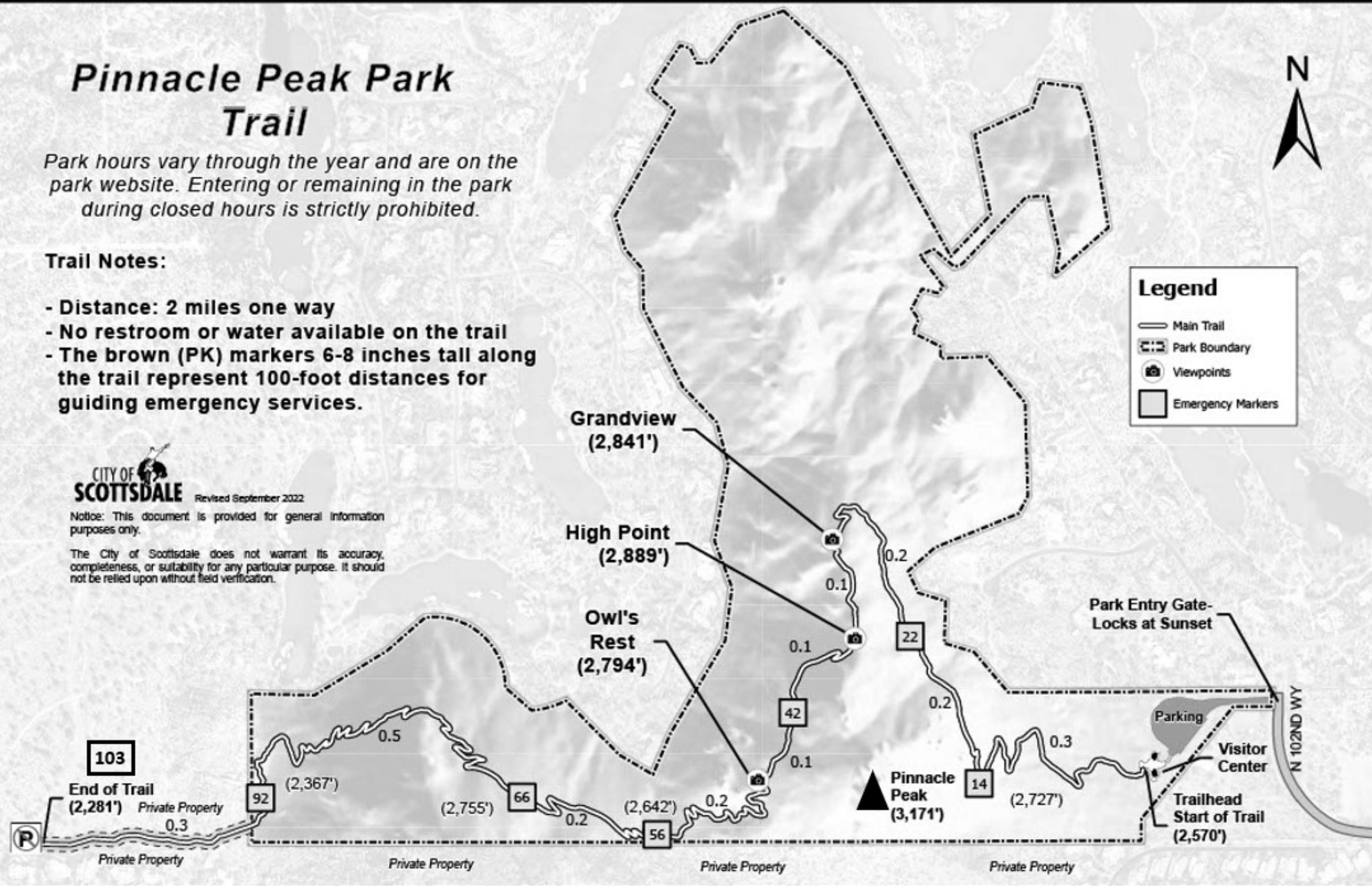

Pinnacle Peak Park Trail

Park hours vary through the year and are on the park website. Entering or remaining in the park during closed hours is strictly prohibited.

For a safe and enjoyable visit please consider the following:

- Carry sufficient water while hiking (when its half gone turn around).
- Be aware of weather conditions such as thunderstorms and excessive heat.
- Stay to the right while on the trail.
- Uphill travelers have the right-of-way.
- No restrooms or water available on the trail

Rules and Regulations:

- No dogs allowed on the trail
- No amplified music (earbud and headphones are welcome)
- No drones
- Stay on the designated trail. No off-trail hiking

Physical Address:

Pinnacle Peak Park
26802 N 102nd Way
Scottsdale, AZ
85262
(480) 312-0990

Mailing Address:

Pinnacle Peak Park
P.O. Box 25089
Scottsdale, AZ
85255

www.scottsdaleaz.gov -
search "Pinnacle Peak Park"

Revised September 2022



Follow us on
Facebook:

